

BinaxNOW[®]

Malaria



IMPORTANT: The instructions below are abbreviated and are intended for users familiar with the test procedure. Consult the Product Insert for detailed instructions and performance characteristics.

TEST PROCEDURE

- 1) **SLOWLY** add 15 μ l of blood from an EDTA tube (or from an EDTA capillary tube) to the **PURPLE** sample pad.

See figure ① on test device.

IMPORTANT: Incorrect addition of sample may lead to an invalid or uninterpretable test.



- 2) Hold the Reagent A bottle vertically and add **two (2)** free-falling drops of Reagent A to the white pad immediately below the purple sample pad. Allow the first drop to absorb into the pad before adding the second drop. See figure ② on test device.



- 3) Allow the blood sample to run up the full length of the test strip. See figure ③ on test device. **NOTE:** If blood flow up the test strip appears to stall or is less than halfway up the strip after one minute, add one additional drop of Reagent A to the white pad at the bottom of the test strip.

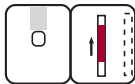

- 4) Just before the blood sample reaches the base of the white pad at the top of the test strip, **SLOWLY** add **four (4)** free-falling drops of Reagent A to the wash pad on the top left-hand side of the device. See figure ④ on test device.

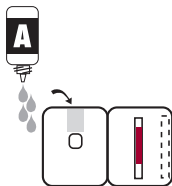

- 5) Remove the adhesive liner and close the device. See figure ⑤ on test device.







- 6) Read the test result 15 minutes after closing the test device.

BinaxNOW[®]

Malaria

RESULT INTERPRETATION

TEST	RESULTS	DESCRIPTION / INTERPRETATION
T1 Positive		Positive result for <i>P. falciparum</i> (P.f.)
T2 Positive		Positive result for <i>P. vivax</i> (P.v.) or <i>P. malariae</i> (P.m.) or <i>P. ovale</i> (P.o.) In some cases the appearance of only the T2 Line may indicate a mixed infection with two or more of P.v., P.m., and P.o.
T1 + T2 Positive		Positive result for <i>P. falciparum</i> (P.f.) In some cases the appearance of both the T1 and T2 Lines may indicate a mixed infection of P.f. with another species.
No T1 or T2 Lines		Negative result (no malaria antigens were detected)

Invalid and / or Uninterpretable Test Results

The test is invalid if the Control (C) Line does not appear, whether a Test Line(s) is present or not.



The test is uninterpretable if the background color hinders reading of the test result at 15 minutes.

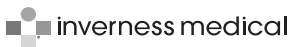

 Binax, Inc
 Scarborough, Maine 04074
 US: 877-441-7440
 OUS: +1-321-441-7200
www.invernessmedicalpd.com



EMERGO EUROPE
 Molenstraat 15
 2513 BH, The Hague
 The Netherlands

BinaxNOW[®] is a registered trademark of the Inverness Medical group of companies.
 © 2009 Inverness Medical. All rights reserved.

Rev. 2 4/13/09
 IN665001