

# BinaxNOW<sup>®</sup>

## Legionella

### Interpretation of Results

Read test results at 15 minutes.

#### NEGATIVE RESULT



ONE pink-to-purple colored Control Line will appear in the top half of the window.

#### POSITIVE RESULT



TWO pink-to-purple colored lines will appear in the window. Specimens with low levels of antigen may give a faint Sample Line. Any visible Sample Line is positive.

#### INVALID RESULT



Sample Line Only      No Lines

The test is invalid when no lines appear, just the Sample Line appears, or background color interferes with the reading of the test.

### Reporting of Results

**Positive** Presumptive positive for *L. pneumophila* serogroup 1 antigen in urine, suggesting current or past infection.

**Negative** Presumptive negative for *L. pneumophila* serogroup 1 antigen in urine, suggesting no recent or current infection. Infection due to *Legionella* cannot be ruled out since other serogroups and species may cause disease, antigen may not be present in urine in early infection, and the level of antigen present in the urine may be below the detection limit of the test.

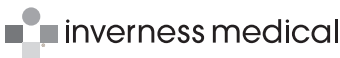

Manufactured by:  
Binax, Inc.  
10 Southgate Road, Scarborough, Maine 04074 USA



EMERGO EUROPE  
Molenstraat 15  
2513 BH, The Hague  
The Netherlands  
Phone: +31.70.345.8570  
Fax: +31.70.346.7299

# BinaxNOW<sup>®</sup>

## Legionella

### Patient Sample Procedure Card

See product insert for complete instructions, including Control Swab procedure.

- 1 Bring patient urine and/or liquid urine control(s) to room temperature (59-86°F, 15-30°C). **Just prior to use**, open pouch, remove test device, and lay flat.
- 2 Dip a BinaxNOW swab into the urine sample, completely immersing the swab head. If necessary, touch swab to side of urine collection container to remove excess liquid.

- 3 Insert patient swab into the hole at the bottom of the device and firmly push upwards so that the swab tip is fully visible in the top hole. **DO NOT REMOVE SWAB.**

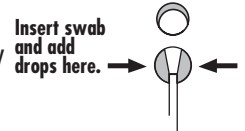

- 4 Hold Reagent A vial vertically, 1/2 to 1 inches above the device. Slowly add 2 DROPS to the **BOTTOM** hole.

**WRONG**

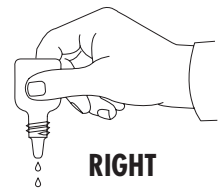

**NOTE:** Improper delivery of liquid reagents can cause **INVALID** test results

- 5 Immediately peel off adhesive liner from the right edge of the test device. Close and securely seal the device. Read result in window 15 minutes after closing the device. Strongly positive patients may be discernible sooner.



**Read Result in Window**

**NOTE:** For convenience, the swab shaft has been scored and may be snapped off **after** closing the device. Avoid dislodging the swab from the well when doing so.